

## ODJ

### Varmgalvanisert stål løsfrens

- d063-180 Boret PN10/16
- d200-1200 Boret PN10

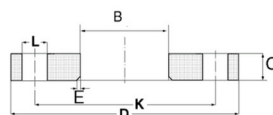

Artikkelnr	NRF	DN	Antall bolthull	B	Bolt	C	D	K	L
ODJ020	2433451								
ODJ025	2433453								
ODJ032	2433456								
ODJ040	1261701								
ODJ050	2433461								
ODJ063	2433463	50/63	4.0	78	M16	18.0	165	125	18
ODJ075	2433466	65/75	4.0	92	M16	18.0	185	145	18
ODJ090	2433469	80/90	8.0	108	M16	18.0	200	160	18
ODJ1000	1261702	1000/1000	28.0	1050	M33	44.0	1230	1160	36
ODJ110	2433471	100/110	8.0	128	M16	20.0	220	180	18
ODJ1200	1261703	1200/1200	32.0	1260	M36	44.0	1455	1380	39
ODJ125	2433473	100/125	8.0	135	M16	20.0	220	180	18
ODJ140	2433476	125/140	8.0	158	M16	22.0	250	210	18
ODJ160		150/160	8.0	178	M20	22.0	285	240	22
ODJ180	1261704	150/180	8.0	188	M20	22.0	285	240	22
ODJ200	1261705	200/200	8.0	235	M20	20.0	340	295	22
ODJ225	2433481	200/225	8.0	238	M20	20.0	340	295	22
ODJ250	1261706	250/250	12.0	288	M20	24.0	395	350	22
ODJ280	1261707	250/280	12.0	294	M20	24.0	395	350	22
ODJ315	2433483	300/315	12.0	338	M20	26.0	445	400	22
ODJ355	1261708	350/355	16.0	376	M20	26.0	505	460	22

Med forbehold om konstruksjonsendringer og tekniske endringer. Kan endres uten varsel.

[gpa.no](http://gpa.no) | [info@gpa.no](mailto:info@gpa.no) | +47 64 85 68 00

## ODJ

### Varmgalvanisert stål løsfrens

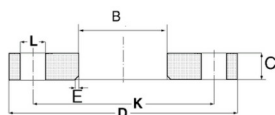

Artikkelnr	NRF	DN	Antall bolthull	B	Bolt	C	D	K	L
ODJ400	1261709	400/400	16.0	430	M24	32.0	565	515	26
ODJ450	1261711	450/450	20.0	487	M24	34.0	615	565	26
ODJ450-500	1261712	500/450	20.0	517	M24	34.0	670	620	26
ODJ500	1261713	500/500	20.0	533	M24	34.0	670	620	26
ODJ560	1261715	600/560	20.0	618	M27	36.0	780	725	30
ODJ630	1261716	600/630	20.0	645	M27	36.0	780	725	30
ODJ710	1261717	700/710	24.0	740	M27	40.0	895	840	30
ODJ800	1261718	800/800	24.0	843	M30	44.0	1015	950	33
ODJ900	1261719	900/900	28.0	947	M30	44.0	1115	1050	33